

# RainScreen Duo Slab®

## Tools required

- Serrated knife or insulation saw

## Installation

### Work on site

RainScreen Duo Slab can be cut to any shape with a serrated knife or insulation saw. It is shrink wrapped in polythene and supplied on pallets that are shrouded with a waterproof hood suitable for outside storage. It is recommended that the sequence of construction is programmed in such way that insulation is left exposed for as little time as possible. While ROCKWOOL insulation is impregnated with a water repelling agent, and is resistant to wind and rain, it is not designed to offer indefinite protection to a substructure.

Depending on the nature of the substrate, a protective membrane may be required. Such design issues will require assessment by a suitably qualified individual.

Subjecting RainScreen Duo Slab to any level of exposure is contingent on a visual inspection of the insulation prior to the installation of the cladding. In the unlikely event that any slabs have become physically damaged or otherwise contaminated, they should be replaced.

Once the weatherproof layer is installed, the resulting ventilated cavity will ensure that any wetted slabs will naturally dry out, regaining all of their original performance and properties.

### Workability

The slabs can be cut to shape or size with a serrated knife or insulation saw, to suit the cladding system.

### Rainscreen cladding – metal rail systems

- To obtain the optimum performance of the system, the slabs should be applied with the patterned side facing outwards (see Figure 3). The resilient inner layer will accommodate surface irregularities (see Figure 2).
- Close-butt the slabs at all vertical and horizontal joints.
- Stagger the horizontal joints of the insulation in accordance with good fixing practice.
- Fix using a combination of metal and polypropylene fixings in accordance with the detail shown in Figure 1. Fixings should have a minimum head diameter of 70mm.
- RainScreen Duo Slab should be cut and tightly fitted around wall brackets where these occur.

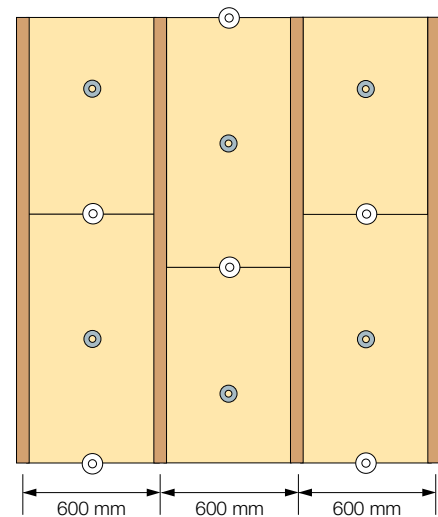

**Figure 1**  
Typical fixing pattern between treated timber cladding rails

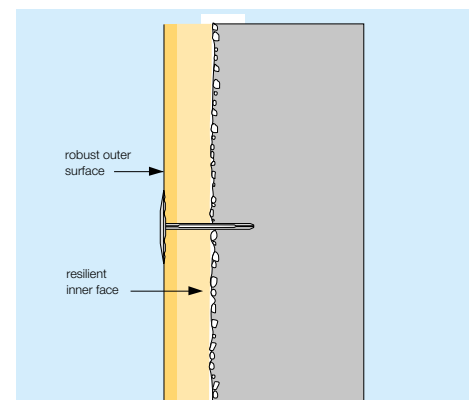

**Figure 2**  
Dual density

### Suitable fixing manufacturers

Hilti: 0800 886100

ITW Construction Products: 01592 771132

EJOT: 01977 687040

Fischer: 01491 827900

### Rainscreen cladding – timber rail application

- The slabs should be tightly fitted between the treated timber rails prior to the installation of the external cladding boards and mechanically fixed as shown in Figure 2. Provision should be made for a minimum 25mm ventilated air space behind the cladding boards.
- All horizontal joints should be closely butted to optimise the insulation performance.

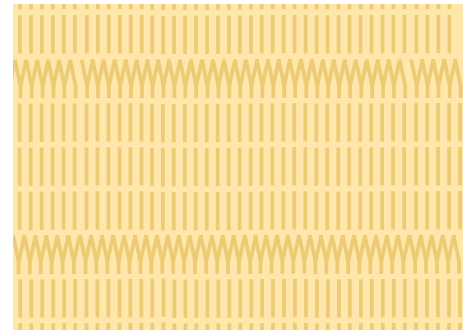

**Figure 3**  
Textured outer face of slab

## Health & safety

The mechanical effect of fibres in contact with skin may cause temporary itching.



Cover exposed skin.  
When working in unventilated area, wear disposable face mask.



Clean area using vacuum equipment.



Waste should be disposed of according to local regulations.



Rinse in cold water before washing.



Ventilate working area if possible.



Wear goggles when working overhead.

## Disclaimers

ROCKWOOL Limited, its affiliates, its agents and employees and all persons acting on its or their behalf (collectively "ROCKWOOL"), disclaim any and all liability for any errors, inaccuracies or incompleteness contained in any installation guidance or in any other disclosure relating to any product.

Usage of the information remains under the sole responsibility of the purchaser and/or user.

ROCKWOOL makes no warranty, representation or guarantee regarding the information contained in the installation guidance, the suitability of the products for any particular purposes or the continuing production of any product. To the maximum extent permitted by applicable law, ROCKWOOL disclaims (i) any and all liability arising out of the application, use of any product, misuse or inability to use the product (ii) any and all liability, including without limitation special, consequential or incidental damages, and (iii) any and all implied warranties, including warranties of fitness for particular purpose, non-infringement and merchantability.

Information contained in this document is up-to-date as at the date of issue. As ROCKWOOL Limited cannot control or anticipate the conditions under which this product may be used, each user should review the information in specific context of the planned use. To the maximum extent permitted by law, ROCKWOOL Limited will not be responsible for damages of any nature resulting from the use or reliance upon the information contained in this data sheet. No express or implied warranties are given other than those implied by law.

Company:	ROCKWOOL Ltd.
Version:	Version: Version 2.00 October 2025 <i>(to check this is the latest version, please refer to <a href="https://rockwool.com/uk">rockwool.com/uk</a>)</i>
Revised on:	22.10.2025
Product name:	RainScreen Duo Slab®
Replaces version:	Version 01 February 2021
Changes made:	<ul style="list-style-type: none"><li>• Updated version control table</li></ul>
Additional information:	N/A

*Please ensure you are using the latest version of this document by verifying it on our official website. Do not rely on printed or previously downloaded copies, as these may be out of date.*

*Please contact the ROCKWOOL Technical Support Team if you would like to access archived versions of this document.*