

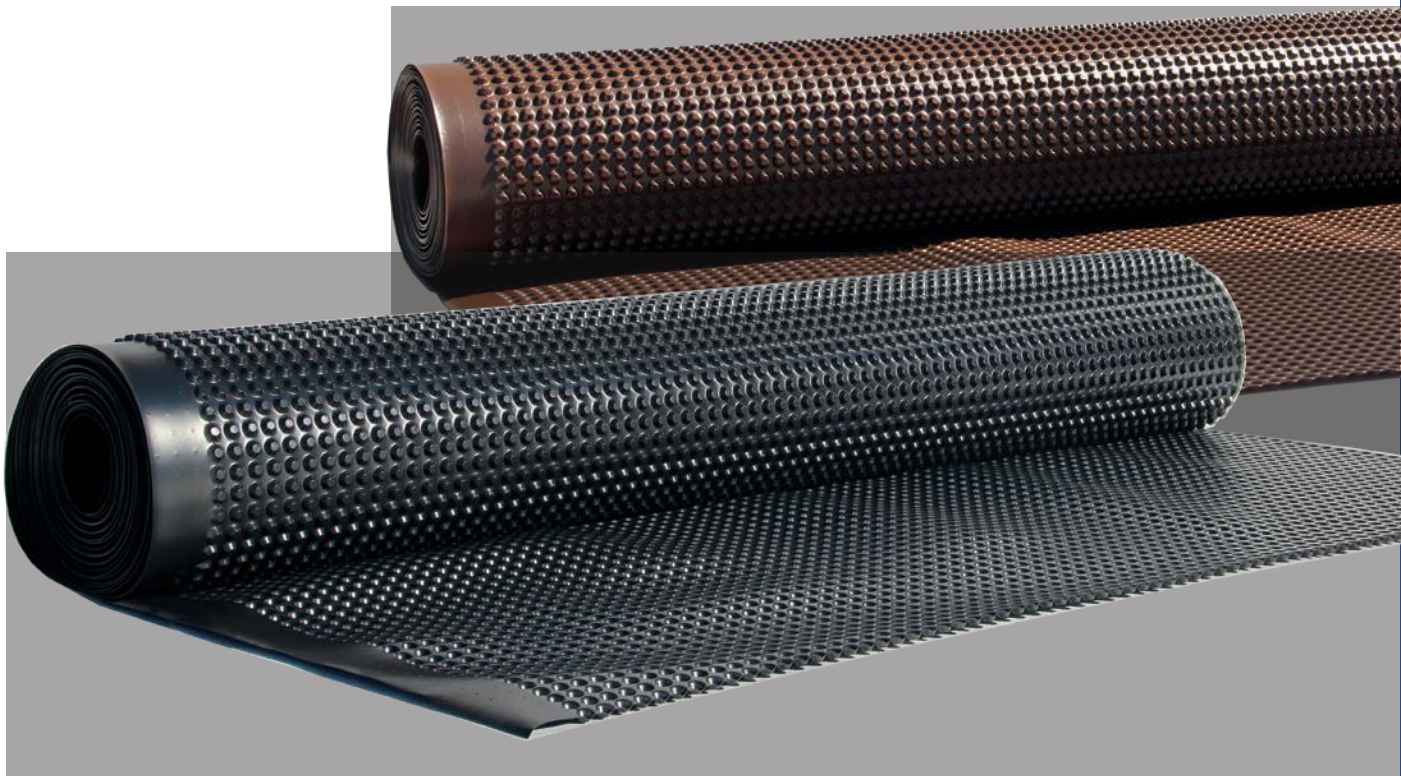

# Protecto-Drain 8



Wallbarn Protect-Drain 8 dimpled membrane with 8 mm high dimples is the high-quality solution for foundation wall protection and sub-bases. These dimpled membranes are manufactured from high-quality, high-density polyethylene (HDPE). HDPE is neutral to groundwater, pollutant-free for disposal and recyclable. The dimpled membranes are used to protect perimeter insulation and on sufficiently pressure-resistant sealing. Thanks to their very good compressive strength and elongation at break, Protecto-Drain 8 offers secure protection when backfilling excavation pits. Moreover, the dimples securely separate the foundation wall and the soil and are also an affordable alternative to lean concrete sub-bases.

## Technical Data

Material	HDPE
Colour	black as standard or brown
Number of dimples	1,710 dimples/m <sup>2</sup>
Dimple height	8 mm
Compressive strength	250 kN/m <sup>2</sup>
Temperature resistance	-30 °C to +80 °C
Fire behaviour	class E
Roll length	20 m
Roll width	1.0 m / 2.0 m Other widths available
Chem. properties	chemical-resistant, rot-proof
Biolog. properties	resistant to bacteria and fungi
Physiolog. properties	safe for drinking water

For more information, visit [www.wallbarn.com](http://www.wallbarn.com)

# INSTALLATION INSTRUCTIONS

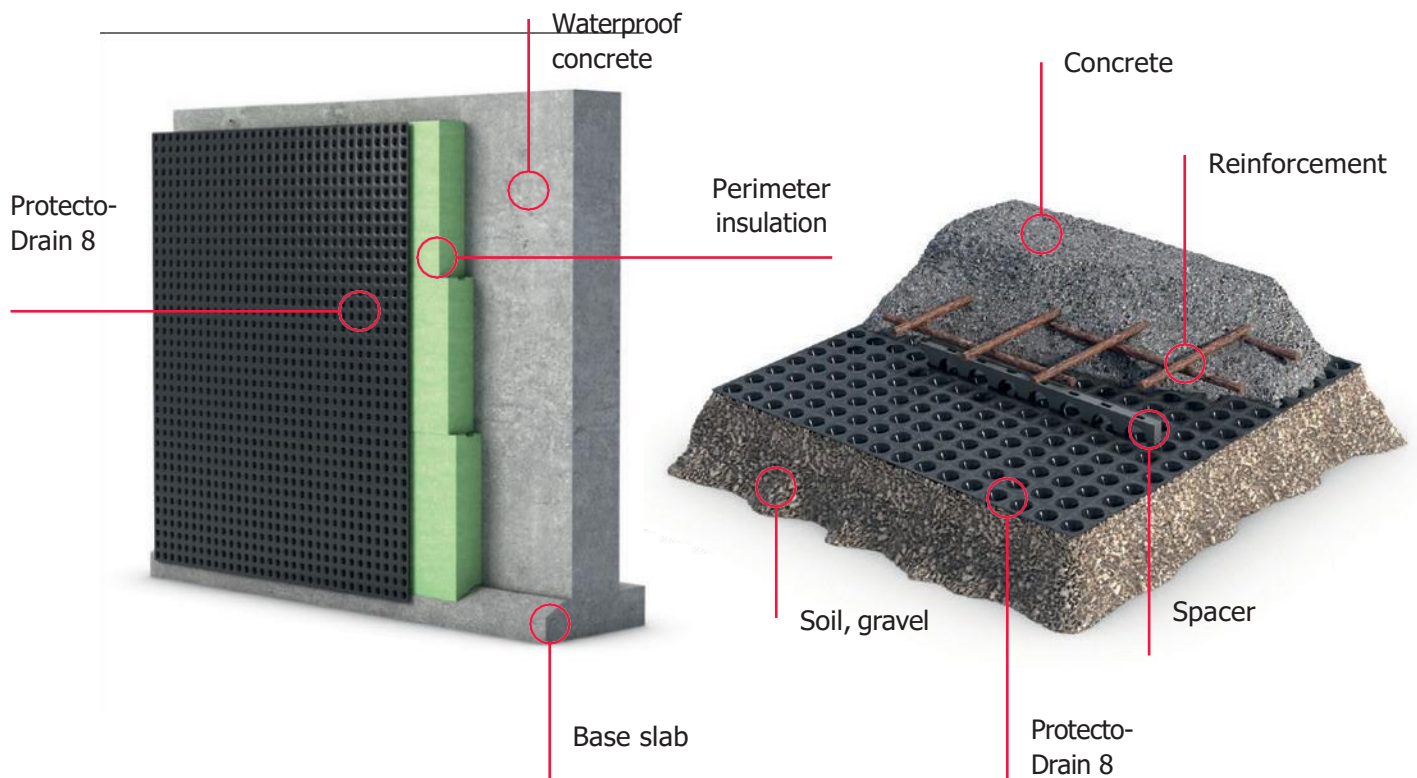

## Vertical

Protect-Drain 8 is laid directly on a pressure-resistant sealing (waterproof concrete or perimeter insulation) with the dimples facing the structure. The membranes must be laid higher than, for example, the perimeter insulation, and fixed there temporarily. Bevel the perimeter insulation at the upper edge. The flat overlapping margin allows a fitting connection. After backfilling, the dimpled membrane is cut to the correct length and completed with the Wallbarn EDGING PROFILE.

## Horizontal

Protect-Drain 8 dimpled membrane assumes the function of the previously used lean concrete. This affords climate-independent working and the elimination of waiting times for allowing the lean concrete to harden. The Protect-Drain 8 dimpled membranes are simply rolled out on the level and stable surface. While doing this, overlap the membranes lengthwise and crosswise by 20 cm. Protect-Drain 8 dimpled membrane also offers protection against rising moisture and prevents cement paste from flowing downwards.

## Accessories:

Wallbarn FIXING STUDS with specially hardened steel nails | Wallbarn EDGING PROFILE made of plastic in black or brown | BUTYL ADHESIVE TAPE |

Wallbarn Ltd

Unit 16, Capital Business Centre, 22 Carlton Road, South Croydon CR2 0BS

Tel: 020 8916 2222 E: [sales@wallbarn.com](mailto:sales@wallbarn.com) W: [www.wallbarn.com](http://www.wallbarn.com)