



# CLASSIC RANGE FIXING INSTRUCTIONS

## All units

Before commencing assembly, pre-drill the base of the upstand with holes of a suitable size to accept the fixings selected to suit the roof structure. They should be positioned 30mm in from the edge of the base flange, 75mm from the corners and at approximately 300mm centres.

## Fixed unit assembly

Pre-drill the base of the upstand (A) as above. Position the glazing assembly (C) onto the upstand. Ensure that clearances are even all round and fix glazing assembly (C) to the upstand (A) with the self-tapping screws (C8). Snap in the security caps (C9). Snap on cover caps (C10).

## Manual opening assembly

Pre-drill the base of the upstand (A) as above. Position the glazing assembly (C) onto the opening frame (B). Ensure that clearances are even all round and fix glazing assembly (C) to the opening Frame (B) with the self-tapping screws (C8). Snap in the security caps (C9). Snap on cover caps (C10). After fitting the rooflight to the structure, fit the manual actuator (D3) using pivot location screws (DS), Bolt (B2a) and nut (B2b). Open and close the unit a few times to ensure it is functioning correctly.

## Electric opening assembly

Pre-drill the base of the upstand (A) (see left). Position the glazing assembly (C) onto the opening frame (B). Ensure that clearances are even all round and fix glazing assembly (C) to the opening Frame (B) with the self-tapping screws (C8). Snap in the security caps (C9). Snap on cover caps (C10). Connect the Chain Drive to the power supply using parts (E5) & (E6) and wiring diagram (E7). Ensure to allow sufficient slack for actuator movement during operation. Note for the actuator to stop in any position it must be connected to the power supply using the wiring diagram (E7), and not as shown in the diagram on the actuator body. Open and close the unit a few times to ensure it is functioning correctly. Before commencing fixing of COXDOME Classic Range rooflights, ensure that roof deck is flat and smooth for at least 200mm around roof opening. Bed the rooflight on a bed of mastic ensuring an adequate seal. Lay rooflight upstand in correct position and fix using 65-75mm No.10 or No.12 Stainless Steel wood screws (not supplied) at approximately 300mm centres and 75mm in from each corner.

**NOTE:** If specified, these rooflights can be fixed to:  
Concrete kerbs using proprietary plugs and wood screws (not supplied).  
Proprietary metal kerbs with M6 bolts and nuts (not supplied).

ELECTRIC ACTUATOR KIT	E
MANUAL ACTUATOR KIT	D
GLAZING ASSEMBLY	C
OPENING FRAME ASSEMBLY	B
UPSTAND ASSEMBLY	A
DESCRIPTION	ITEM

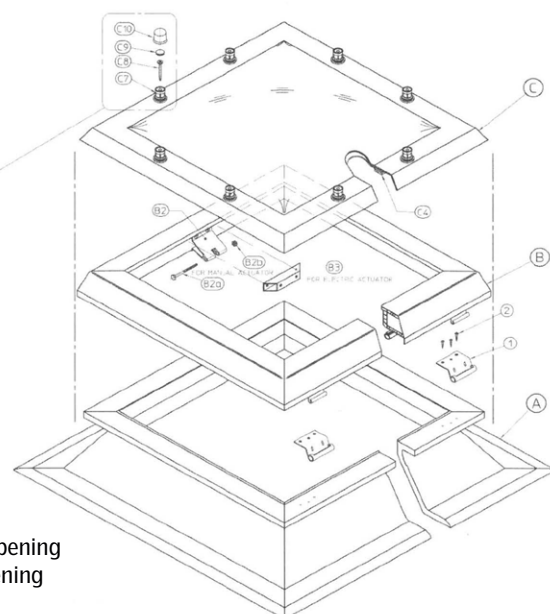
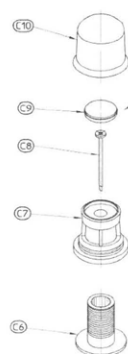

COXDOME is a UK manufacturer, providing natural daylight and ventilation solutions since 1954



COXDOME part of VELUX Commercial

0121 530 4230  
sales@coxdome.co.uk  
www.coxdome.co.uk

Unit A1, Link One Industrial Park,  
George Henry Road, Tipton, DY4 7BU