

Uni-Line Continuous Dry Verge



The Uni-line Continuous Dry Verge provides a watertight and secure mortar free verge system.

Product features & benefits

- Single piece product is quick and easy to install
- Requires no special tools to install
- All weather fixing, weatherproof and maintenance free
- Ideal for use with PVC-U bargeboards, fascias and soffits
- UV stabilised for long-term protection
- Prevents entry of birds and large insects
- Gives extra security at verge against wind damage
- Can be used on existing roofs ('T' Strip only)
- Mortar-free, eliminating wet trades and associated problems
- Unaffected by settlement or differential movement
- Neat attractive finish
- T-strip connectors allow for a sprocket eaves and change in pitch up to 15°

Area of application

Suitable for:

- Refurbishment or new build on roofs from 12.5° to 90°
- **'T' Strip** – suits most plain and profile concrete interlocking tiles. For bold roll and double pantile, fit the 'T' Strip on top of batten.
- **'S' Strip** – suits all fibre cement, natural and synthetic slates up to 8mm in thickness.
- **Scot Strip** – suits all fibre cement, natural and synthetic slates, up to 8mm in thickness, on boarded roofs with top of batten fixing.



Material

UV stabilised UPVC

Dimensions (approx size)

T Strip	130mm x 94mm
S Strip	90mm x 63mm
Scot Strip	80mm x 45mm

Installation

1. The top of the gable wall should be reasonably level and free from obstructions. The roofing felt should be carried across the cavity and the battens fixed in the usual way, ensuring that they finish flush with the other wall or outer edge of the bargeboard.
2. Select a verge strip of the same or slightly greater length and cut to fit.
3. Make sure that the verge strip is taken to within 25mm (1") of the apex at the ridge. At the eaves, a piece should be removed from the horizontal flange in order to carry the line of the sprocket. (see illustration A)
4. The horizontal flange of the verge strip is inserted between the batten and the top of the wall (see B).
5. As the tiles are laid, ensure that the verge tiles are extended fully into the verge strip where they will be firmly held (see C).
6. T-strip connectors allow for a sprocket eaves and change in pitch up to 15° (see D).
7. For the Scot Strip follow the instructions above but fix directly onto boarding (see E).
8. Klobber recommends that the continuous dry verge is either screwed into the brickwork or nailed into the end rafter.

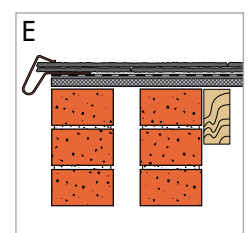
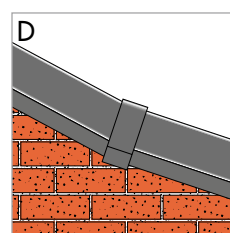
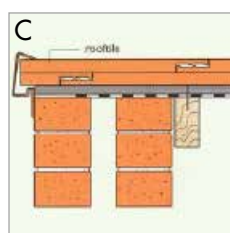
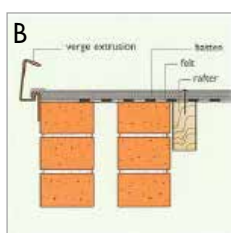
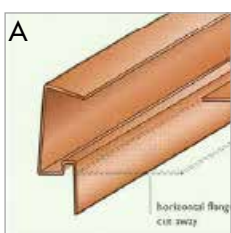

Klobber Ltd

Unit 6F · East Midlands Distribution Centre · Short Lane · Castle Donington · Derbyshire · DE74 2HA
Tel. +44 (0)1332 813 050 · Fax +44 (0)1332 814 033 · www.klobber.co.uk · info@klobber.co.uk

KLOBBER

Uni-Line Continuous Dry Verge



Colour / Product Codes

'T' Strip – Black	KR980376
'T' Strip – Brown	KR980378
'T' Strip – White	KR980377
'S' Strip – Black	KR980476
Scot Strip – Black	KR980676

Packaging

4 x 5m lengths per pack

Related Products

Connectors (for 'T' Strip only)

Black	KR980576
Brown	KR980578
White	KR980577

Ridge End Caps

	Half Round	Universal Angle
Black	KR977276	KR977376
Brown	KR977236	KR977336
White	KR977277	KR977377

Regulations

Complies fully with all relevant British Standards including BS 8612.

'T' Strip

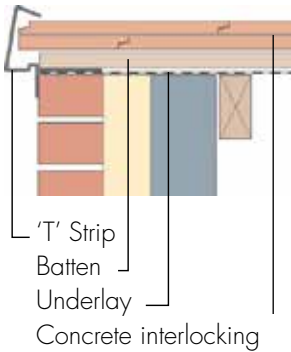

'S' Strip

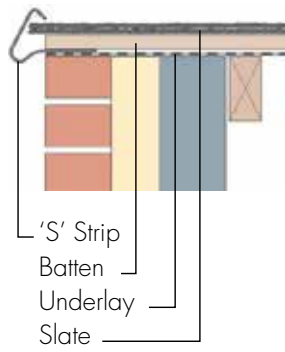

'Scot' Strip

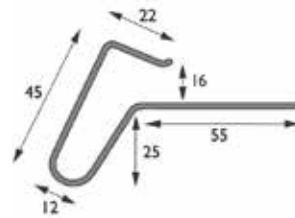
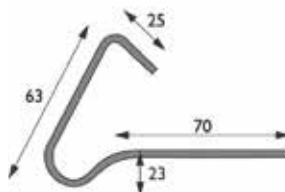
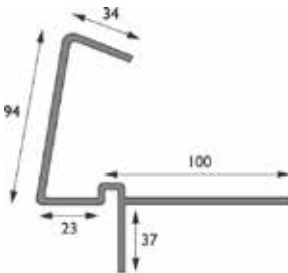
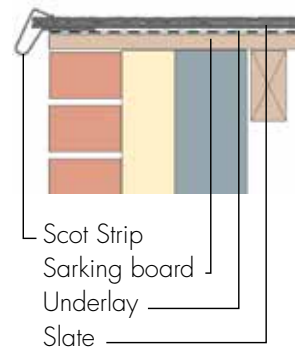

TS-05#13-UK-1016. We assume no liability for typing errors.

Klober Ltd

Unit 6F · East Midlands Distribution Centre · Short Lane · Castle Donington · Derbyshire · DE74 2HA
Tel. +44 (0)1332 813 050 · Fax +44 (0)1332 814 033 · www.klober.co.uk · info@klober.co.uk

KLOBER